

# DIN 7337

## Blindnieten

### Form A - Flachkopf

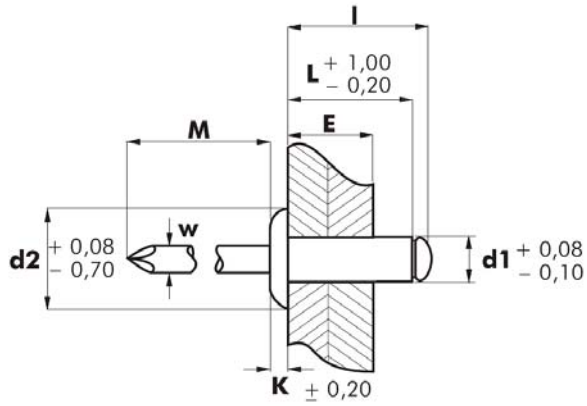

d1	2,4	3,0	3,2	4,0	4,8	5,0	6,0	6,4
d2	5,0	6,5	6,5	8,0	9,5	9,5	12,0	13,0
l								
4								
5								
6								
7								
8								
10								
12								
14								
15								
16								
18								
20								
21								
22								
24								
25								
26								
27								
30								
32								
35								
40								
45								
50								

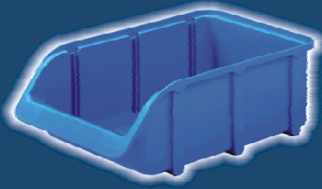

# DIN 7337

## Blindnieten

### Form B - Senkkopf

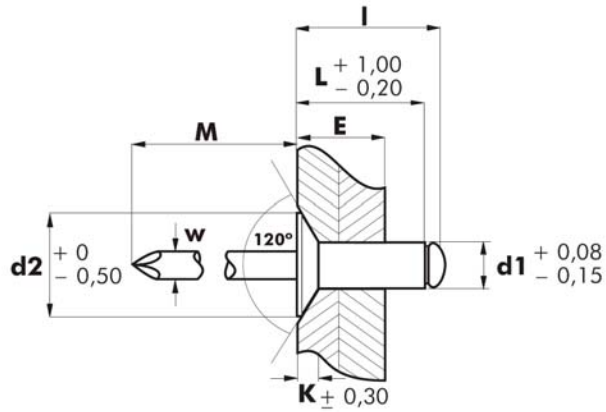

d1	3,0	3,2	4,0	4,8	5,0
d2	6,0	6,0	7,5	9,0	9,0
l					
6					
8					
10					
12					
14					
15					
16					
18					
20					
21					
22					
24					
25					
26					
27					
30					
32					
35					
40					
45					
50					

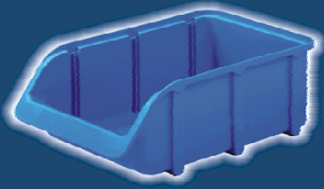

# DIN 7337

## Blindnieten

### Großkopf

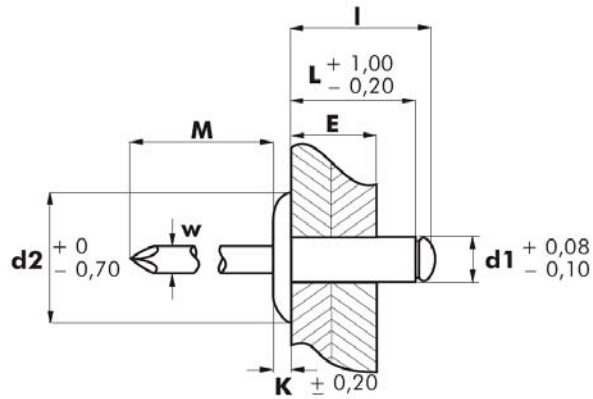

d1	3,2	4,0	4,8	4,8	5,0	5,0
d2	9,5	12	14	16	11	14
l						
6						
8						
10						
12						
14						
16						
18						
20						
21						
24						
25						
27						
30						
35						
40						
45						
50						